

VT3 PRO

INTRODUCTION AND USER'S GUIDE

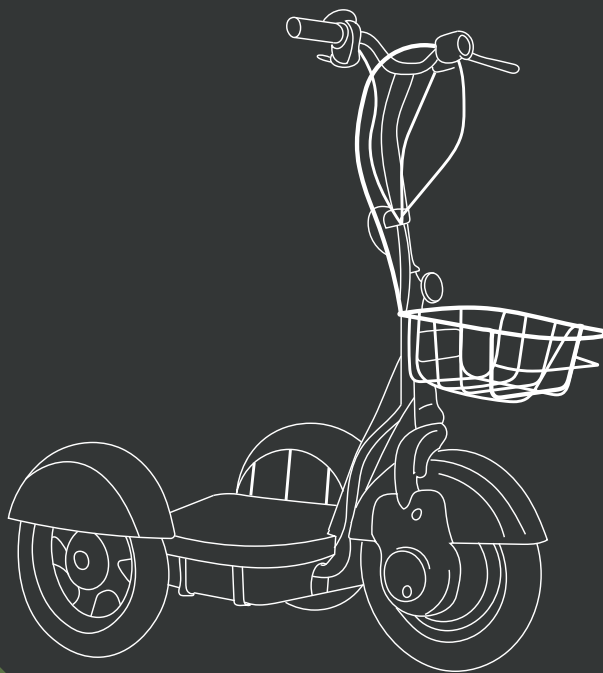

Read this manual carefully before using your vehicle.

PREFACE

This vehicle is designed for an environmentally friendly transportation. Throughout the guide you will see the advantages and characteristics of the vehicle. Its general specifications are as follows;

- High efficiency brushless DC motor
- Electronic control unit (Controller) which protects from high and low voltage.
- Braking system with electric cut-off feature for safe driving.
- High capacity battery providing longer range and high performance
- Front suspension providing a pleasant and comfortable driving pleasure.

IMPORTANT NOTE

Driver and Passenger

- This vehicle is designed to carry a maximum of one driver.
- Please use your vehicle without exceeding the load limits written on the vehicle's certificate of conformity.

Road Condition

- This vehicle is designed for use on flat and asphalt roads.
- Do not use the vehicle without reading the entire user manual.
- It is recommended that you read the "Warning, Caution, Note and Safety Precautions" sections carefully.
- **One month after purchasing your vehicle, you should take it to the nearest authorized service center or distributor for maintenance.**



WARNING

- It is obligatory to comply with the maintenance intervals written in the user manual. Otherwise, your vehicle will be out of warranty conditions. The maintenance intervals for your vehicle and the parts that need to be changed/checked are listed in this user manual.
- These headings are written to protect you from serious personal injury and mechanical damage.



CAUTION

- These headings are written to protect you from serious personal injury or potential accident.

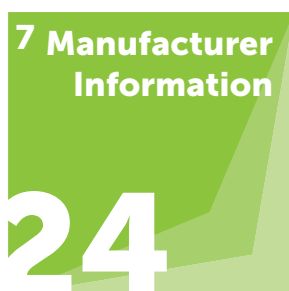
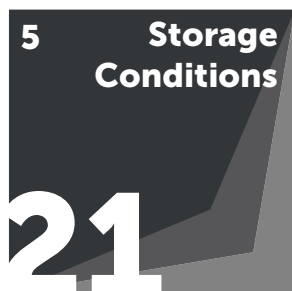
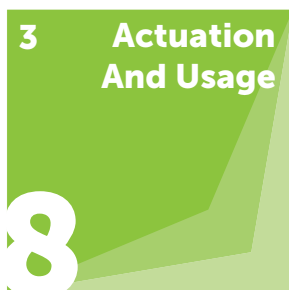
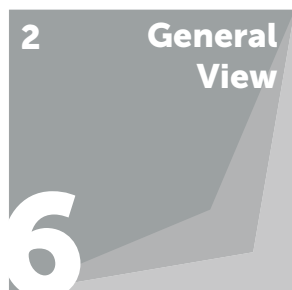

1. SAFE DRIVING

Pre-Riding Instructions

- Check the condition of all the movable parts
- Check all rotating parts and add oil if it is missing.
- Check whether the tyres are intact.
- Check the tyre pressures.
- Make sure that all nuts and bolts are tightened adequately.
- Check that the brake cable and other cables are not pinched and are working properly.
- Make sure the throttle is working properly.
- Check all lighting systems.

Safe Driving Instructions

- Follow the pre-ride instructions before starting to use.
- Grasp the grips with both hands while riding.
- Make sure you maintain a safe driving position.
- Practice often, primarily to gain experience.
- Obey the maximum loading conditions specified in the manual.
- Objects moving while driving will change the vehicle's center of gravity and will endanger the driving safety. Take the necessary measures to avoid this situation.
- Avoid acrobatic movements while driving your vehicle.
- Avoid high speeds when turning.
- Wet weather lengthens the braking distance and restricts maneuverability. In such cases, always maintain your low speed.
- Avoid excessive puddles that may occur in rainy weather.
- Do not use under the influence of alcohol and drugs.
- •Accessories such as knee pads, elbow pads, goggles, protective gloves, etc. are protective equipment that will reduce your risk of serious injury. However, you should definitely wear a helmet before driving.
- •Most of the accidents happen because they are not noticed in traffic. To avoid this, wear clothes that reflect the light in traffic and make it easier to be noticed.



WARNING

- Do not enter curvy road with your vehicle at high speeds. This can cause your vehicle to rollover and endanger your life.

Efficient Driving Instructions

- If the following efficient driving instructions are followed, your vehicle's driving range and efficiency will increase;
- Take your vehicle to service regularly.
- Comply with the maximum load limits in the manual.
- Be careful about using your vehicle in suitable weather and road conditions.
- Check all tyres before riding, that your tyre pressures are appropriate.
- Pay attention to the maximum speed limits.

2.GENERAL VIEW



-
- | | |
|--------------|--------------------|
| 1. Basket | 5. Ignition |
| 2. Hub Motor | 6. Throttle Lever |
| 3. Rear Tyre | 7. Indicator |
| 4. Headlight | 8. Stability Wheel |



CAUTION

- All parts listed in the user manual are for reference. The manufacturer can make changes without notice.

2.1. GENERAL VIEW



-
- | | |
|-------------------------|--------------|
| 1. Horn | 4. Indicator |
| 2. Forward-Reverse Gear | 5. Ignition |
| 3. Headlight | |

CAUTION

- All parts listed in the user manual are given as reference. The manufacturer can make changes without notice.

3. ACTUATION AND USAGE

Actuating

Insert the ignition key into the ignition switch and place it in the on position. The vehicle will be ready for driving.

Headlight

If you turn the ignition again after the vehicle has started, it will switch on the headlights.

Acceleration and Deceleration

- Turn the throttle lever downwards. In this case, your vehicle will move. The speed can be increased or decreased with the throttle. Turn the throttle indirection (a) to increase your speed, or (b) to decrease speed.



Loading

- Front basket can be used to handle light loads.
- Please do not exceed the permissible load limits. Front basket maximum carrying capacity: 10 kg.
- Please do not carry loads on surfaces that are not suitable for transporting loads on the vehicle. Otherwise, these parts will be damaged.

3. ACTUATION AND USAGE

Braking

There are braking sensors in the brake lever and foot brakes. In this way, the brakes both provide mechanical braking as well as cut the energy of the motor.

- Grasp the brake lever with your fingers and gently squeeze it towards you.
- Slowly loosen the brake lever to stop braking.
- Avoid sudden and hard braking. Otherwise, your vehicle may slip and cause accidents.
- Be careful when braking on downhill descents.

Front And Rear Brake

Your vehicle has a drum brake system. For brakes, the brake lever free travel must be 10 to 20 mm. After this distance, the braking process must begin.

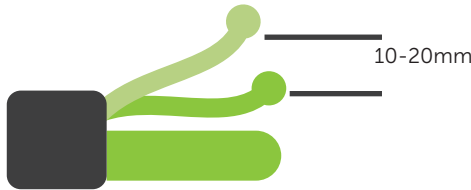

WARNING

- Brake pads must always be replaced with original products. Poor quality parts can damage other parts of the vehicle. It also affects the performance of your vehicle.

3. ACTUATION AND USAGE

Charger

- Before its first ride charge the vehicle for 7-8 hours. Please observe the following instructions to vehicle the vehicle;
- Make sure your electric motor is switched off.
- First plug the part of the charger marked "2" into the wall socket.
- Then insert the part of the charger marked "1" into the charging port on your vehicle.
- Arc/spark may occur when installing the charger on the vehicle.
- Two warning strips are located on the charger. The first LED is solid red, indicating it is working, while the other LED turns red during charging and green when the battery is full. If the charger has a red green color, the battery is full. If your charger is a single LED, it turns red during charging and green when charging is finished.
- Wait until the light on the indicator is green.
- After the charging has been completed, remove the plug from the charging port and the charger from the wall socket. Disconnecting the charger from the wall socket will extend the life of the product.

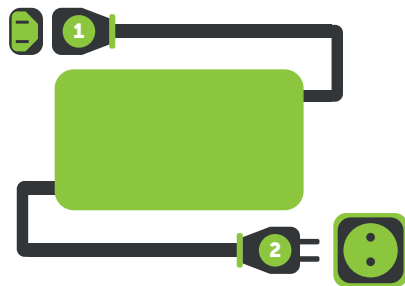

WARNING

- Damaged chargers due to voltage differences in your electrical installation may damage your vehicle. These types of faults are not covered by the warranty.
- Plugging the charger into the socket first will protect your vehicle from possible high/low voltage situations.
- Charging at least once a month will extend the life of your battery.
- **When the battery is fully charged, disconnect it from the charger.**

CAUTION

- If the battery charge time exceeds the time specified in the manual, please contact the authorized services.
- During the winter, the performance of the battery and range of your vehicle may decrease.
- Use only the original charger specifically designed for your product.
- Your electric motor bike must be switched off when charging.
- Never shake your vehicle when charging.

3.ACTUATION AND USAGE

Battery

- Do not remove batteries.
- Keep batteries away from children.
- Do not combine the anode and cathode of the battery when charging or discharging. Never use any conductors between the anode and the cathode. It will cause a short circuit.
- Avoid contact with water from your battery.
- Protect batteries from temperatures of 60°C(140°C) and above.
- Do not subject to physical impacts such as hitting, throwing, dropping. Do not tamper with batteries with cutting, drilling tools.
- If a leak occurs and comes into contact with your skin or eye, immediately wash it with water and go to the nearest health care facility.
- If physical changes such as smell, heating, burning, color change are seen in the battery, separate the battery from your vehicle and move away.

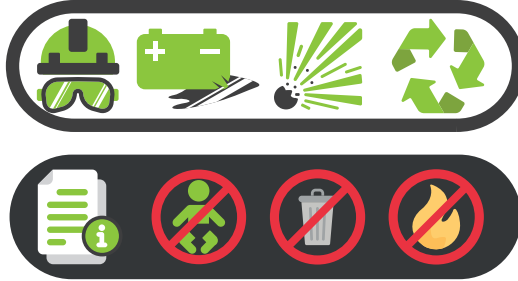

WARNING

- Keep your electric motorcycle away from the cold, if possible, in your garage. This will prolong the life of your battery.
- If you do not use your electric vehicle for a month or more, recharge the batteries at least once a month. This application helps you to maintain the performance of the battery.

4.MAINTENANCE AND CONTROL

Brake Maintenance

Brake pads wear out due to the working principle. It should be replaced when it reaches certain safety levels. Inspection of this safety level and change of pads should be done by authorized services. Unreplaced brake pads cause the brake system to work poorly, make noise, and in some cases, break other parts. Brakes should be checked at every service period.

Tyre Pressure Check

Check the pressure levels of your tyres daily. Tyre pressures above and below the norm will affect the vehicle's handling, acceleration, energy consumption and similar performances.

Check your tyres daily for punctures, cuts or any other unusual condition. Also on the rims; crushing, scratching and inclination can cause pressure loss. This type of damage can cause your vehicle to unbalance and vibration. In case of such situations, please visit the nearest official service point and have the damage repaired.

	Size	Tyre Pressure
	14-2.50	240-310kPa/35-45 psi
	14-2.50	240-310kPa/35-45 psi

CAUTION

- If the tyre does not have the correct air pressure, it will wear out more quickly and its life will be shortened, as well
- deflated tyres may cause an accident as they reduce grip.
- In case of very low air pressure, the tyre may come off the rim.
- Your tyres will wear out as you use them. You should change your tyre when your tread depth decreases. Depending on the road, climate and usage conditions, your tyre life may be extended or shortened. Drivers should check tire pressure and tread depth regularly. Tyres with low tread depth will reduce grip, especially on wet surfaces. Minimum tread depth is 1.5 mm for front tyre, 2.0 mm for rear tyre. Such situations cause accidents.

4.MAINTENANCE AND CONTROL

Change of Circuit Breaker

- The vehicle's charging circuit is protected by a 30 a fuse against interference from outside and charger breakage. If it fails, it must be replaced. For this;
- Make sure the vehicle is in the closed position.
- Replace it with a fuse with equivalent



CAUTION

- Areas where high electric current flows in the vehicle are covered with orange cables. Never interfere with these cables except for the authorized services.
- The use of circuit breaker below the specified capacity causes continuous circuit interruption of the system, and the use of circuit breaker above the specified capacity causes the deterioration of electronic parts due to high currents. This may cause damage to the cables so to the vehicle.
- Do not use high pressure water while washing your vehicle. It will damage your electrical systems.

Adjusting the Throttle Handle

- Check that the throttle can move easily.
- The distance from the highest position to the first throttle response should be between 2 and 6 mm. To adjust this, loosen the jam nut, turn the adjuster and tighten it again.

Controller / Motor Maintenance

- Your vehicle's electronic control unit (controller) is located under the seat. For this reason, make sure that this area does not get water, the cables entering this area are not strained and the protective plastic does not get impacted.
- Do not use the throttle lever and service brake system at the same time in order to prevent deterioration of other parts.
- Slow down when the road surface is bad. Excessive vibrations may cause the cables in the motor and controller to get damaged.
- Do not allow the water level to reach the level of the motor in rainy weather. Otherwise, your motor will break down.

Cleaning

- It is recommended to clean your electric vehicle with a wet cloth.
- Never lubricate the brake system and tyres.
- Use oil to clean the metal parts of your vehicle. Always use standard cleaning materials when cleaning painted plastic parts.
- Rinse with fabrics after cleaning.

4.MAINTENANCE AND CONTROL



WARNING

- Never use water at too high pressure when washing your electric vehicle, as water at high pressure may cause some of your parts to get water. Parts that receive water have a reduced life and can deteriorate.

Maintenance Interval

- Even if your vehicle is running smoothly, it should be checked at certain intervals by the authorized repairers. These intervals are detailed in the operator's manual on the following pages. Vehicles that have experienced problems or have been in an accident must be taken directly to the dealer without waiting for a maintenance interval. In such cases, repairs must be carried out with the original part.
- Any modification of the vehicle to provide maintenance, repair, modification or any performance improvement other than contracted service stations with manufacturer approval will result in the product being excluded from warranty.

First Maintenance

- 1st and 4th month maintenance is important for your vehicle. After the first use, the motor parts get used to each other and it is recommended to check all the bolts during the first maintenance.
- The reliability of your vehicle depends on the correct first use and first periodic maintenance.



CAUTION

- Please stay away from modifications to make your vehicle safe and long-lasting. Modified vehicles will endanger the safety of you and the traffic. Always use approved parts by the manufacturer.
- For your personal safety, turn off the motor before any maintenance.
- If the vehicle has not been used for 1 month or more, check the parts that are likely to corrode, such as tyres and batteries, and start driving.

4.MAINTENANCE AND CONTROL

Motor Code And Vehicle Identification Number

Motor code and vehicle identification number are for help our authorized services in order to provide better service to you in case of need for maintenance / repair.



Motor Code



Vehicle Identification Number



WARNING

- Make sure that the motor and chassis numbers on your electric vehicle are the same as those on the certificate of conformity.

4.MAINTENANCE AND CONTROL

Periodic Maintenance

- Periodic maintenance should be done at authorized technical service stations.
- Vehicles that are not regularly maintained (once every 4 months) will be evaluated out of warranty.



WARRANTY MAINTENANCE CARD
PERIODIC MAINTENANCE TABLE

1. MONTH STAMP Date:...../...../.....	4. MONTH STAMPS Date:...../...../.....	8. MONTH TAMP Date:...../...../.....	12. MONTH STAMPS Date:...../...../.....	16. MONTH TAMP Date:...../...../.....	20. MONTH STAMP Date:...../...../.....
24. MONTH STAMPS Date:...../...../.....	28. MONTH TAMP Date:...../...../.....	32. MONTH STAMPS Date:...../...../.....	36. MONTH TAMP Date:...../...../.....	40. MONTH STAMPS Date:...../...../.....	44. MONTH TAMP Date:...../...../.....

4.MAINTENANCE AND CONTROL

ELECTRIC VEHICLES MAINTENANCE TABLE

PART/ SYSTEM NAME	ACTION TO BE TAKEN	MONTH OF MAINTENANCE * Month or km, whichever comes first.						
		1. Month CONTROL	4. Month (2.000 KM)	8. Month (4.000 KM)	12. Month (6.000 KM)	16. Month (8.000 KM)	20. Month (10.000 KM)	24. Month (12.000 KM)
FRONT AND REAR BRAKE	Check that the brake cables are not pinched and work properly, adjust if necessary.	●	●	●	●	●	●	●
	Replace the brake pads if necessary.	●	●	●	●	●	●	●
	Check and adjust the brake lever clearances.	●	●	●	●	●	●	●
	Check the operation of the brake sensors.	●	●	●	●	●	●	●
	For vehicles with hydraulic disc Check the hydraulic oil lever and any leaks.	●	●	●	●	●	●	●
	Check the brake discs.	●	●	●	●	●	●	●
Connectors	Make sure all nuts and bolts are adequately tightened.	●	●	●	●	●	●	●
Battery	Measure battery voltage, fully charge or replace if necessary.	●	●	●	●	●	●	●
	Check the terminals are tight.	●	●	●	●	●	●	●
Tyres	Check tyre pressures, tyre damage and tread depth.	●	●	●	●	●	●	●
Wheels	Check for runout or damage.	●	●	●	●	●	●	●
Wheel Bearings	Check that there is no play in the hub and that the wheels turn freely.	●	●	●	●	●	●	●
Handlebar Bearings	Check if the handlebar bearings are worn or loose. Replace if necessary.	●	●	●	●	●	●	●
Front Suspension	Check the spreading. Check the inner tube of the shock absorber for scratches, damage or excessive lubrication.	●	●	●	●	●	●	●
Rear Suspension	Make sure that it does not make any annoying noise while operating and there is no oil leakage.	●	●	●	●	●	●	●
Throttle Lever	Check if the throttle lever is connected and functional.	●	●	●	●	●	●	●
Charger and Socket	Check operation and connections.	●	●	●	●	●	●	●
Chain (if equipped)	Check tension and lubricate.	●	●	●	●	●	●	●

NOTE: Your vehicle should be serviced first at 500 km or 1 month (whichever comes first)

The first maintenance is for control purposes. Your second maintenance after the first one will be done when your vehicle reaches 2000 km. After this maintenance, your every maintenance will be in the form of 2000 and its multiples. The time between any two maintenance should not exceed 4 months. The owner who does not reach the maintenance intervals in more than 4 months should also take the product to the authorized service for maintenance. Vehicles which do not comply with maintenance intervals and kilometers will be out of warranty.

-The warranty period starts from the date of delivery of the goods to the owner, in accordance with the warranty certificate regulation, and for motorcycles and ATV vehicles, it is 1 years or 30,000 km (whichever comes first), other vehicles (e-bike, electric skateboard, electric motor bike, etc.).) for 1 years.

VOLTA MOTOR SAN.Tİ.C.Ş
Setamlar Köyü Setamlar Meykili Gumusova
OSB 1. Sokak Blok No: 10
Gumusova / DUZCE



RE-VOLT



0380 731 25 25 0380 731 25 35
info@volta.com.tr

5.STORAGE AND HANDLING

Storage

- If you are not going to use your electric vehicle for a long time during periods such as winter , you should take some precautions to protect your vehicle from malfunctions and corrosions. It would be better to make some repairs before storage.
- Clean, rinse and dry your electric vehicle. Coating the painted surfaces with protective oil will extend the life of your paint and ensure that it retains its first day's shine.
- Bring the tire pressure of your electric vehicle to the ideal level.
- Put on your vehicle a cover which will be either plastic or non-rubber.
- Take care to store in storage conditions where the air temperature does not change much. High temperature change can cause fatigue, deterioration and cracking of many parts of your vehicle.

Get In Use

- Remove the cover from the electric vehicle and clean.
- Start the vehicle after completely following the pre-starting instructions.
- Make the first use in a traffic-free area. After making sure that all parts of your electric vehicle are working correctly and at full performance, drive out to traffic.

Transport

Do not carry loads that are not suitable for carrying loads on your electric vehicle. Otherwise, the vehicle will be damaged.

Assembly

- The electric vehicle is delivered assembled.

6.TECHNICAL SPECIFICATIONS

Parameters	
Length	1135 mm
Width	738 mm
Height	1125 mm
Weight	45 kg
Maximum Carrying Capacity	85kg
Motor Power	220W
Motor Type	BLDC Hub Motor
Battery Capacity	48 V 14 Ah
Battery Type	VRLA Jel
Charger Capacity	48-57V, 1.8A +/- 1.2A
Charger Time	6-8 hours
Maximum speed	25 km/h
Range	40 km
Front Brake	Drum
Number of Seating Positions	1(Optional)

7. MANUFACTURER INFORMATION

The service life of your Volta brand vehicle is 10 years and the maximum repair period is 45 days. If you encounter any problems with your vehicle, you can visit our website at www.volta.com.tr and access information about authorized services and spare parts.



You can access all authorized service station information from the Service Information System created by the Ministry

MANUFACTURER

VOLTA MOTOR SAN. VE TIC. A.S.

Selamlar Koyu, Selamlar Mevkii,
Gumusova OSB 1. Sk. No:10 Gumusova/DUZCE/TURKEY
Tel : 0850 222 28 65 - 0380 731 25 25
E-Mail: info@volta.com.tr

VOLTA MOTOR SAN. VE TIC. A.S.

Yaka Mahallesi 401.Sokak No:19 Cumayeri / DUZCE
Tel : 0850 222 28 65 - 0380 731 25 25
E-Mail: info@volta.com.tr

VOLTA MOTOR SAN. VE TIC. A.S.

- TUBITAK Technology Free Zone
Tubitak MAM Teknoloji Serbest Bölgesi Baris SB. Mh. 5001 Sk. No:3 A/B
Gebze/KOCAELI /TURKEY
Tel : 0850 222 28 65
E-Mail: info@volta.com.tr

VOLTA USA LLC

2323 Main St., Suite R6, Irvine, CA 92614 / UNITED STATES
E-Mail: us@vtamobility.com

VOLTA MOTOR GERMANY GmBH

Handwerkerstraße 3, 15366 Hoppegarten Berlin / GERMANY
E-Mail: de@vtamobility.com

VOLTA MOTOR UNITED KINGDOM

Swift Business Park UNIT 3 Rainham / London / UK
E-Mail: uk@vtamobility.com

8.GUARANTEE

MANUFACTURER

Trade Name	Volta Motor Sanayi ve Tic. A.Ş.		
Address	Selamlar Köyü Selamlar Mevkii Gümüşova OSB 1 Sokak Blok No: 10 Gümüşova/Düzce/ TÜRKİYE	Tübitak MAM Teknoloji Serbest Bölgesi Barış SB. Mah. 5001 Sok. No: 3 A/B Gebze/KOCAELİ	
Phone	+90 850 222 28 65	+90 850 222 28 65	
Fax	+90 850 222 28 65	+90 850 222 28 65	

Type	Electric Vehicle
Commercial Name	VOLTA, VTA
Model	VT3 PRO
VIN	
Delivery Date and Place	
Maximum Repair Time	45 Working Days
Warranty Period	1 YEARS

Trade Name	
Address	
Phone	
Fax	
Invoice Date and Number	
Date of Sale	

This section must be filled in completely by the seller.(STAMP AND SIGNATURE)

TERMS OF VALIDITY AND SCOPE OF THE WARRANTY

1. The warranty period of the vehicle is one year and the warranty covers only the supply of spare parts. Spare parts will be sent if the warranty conditions are met stated in this user manual. In order to benefit from warranty it is necessary to submit Warranty Certificate that must be kept for the duration of the warranty.

2. The use of the product in violation of the terms in the user manual and the resulting malfunction in the product are considered as usage errors and are considered out of warranty.

3. In the event that the goods are found to be defective, the consumer may use following rights as specified in the Turkish Commercial Law No. 6102 and Protection Consumer Law No. 6502, Article 11;

a) Withdrawing from the contract by declaring that it is ready to return the sold item,

b) With holding the sold item and requesting a discount from the sales price at the defect rate,

c) Requesting free repair of the sold item at the seller's expense, unless an excessive expense is required

ç) If possible, he may use one of his optional rights to request that the sold product be replaced with a non-defective one.

4. Since the invoice will be taken into account in case of disputes that may arise within the warranty period, it is obligatory to submit the approved Warranty Certificate and invoice.

5. The warranty will be voided if any damage is done on the invoice and warranty document, when the original serial number on the vehicle is removed or if it is determined that it has been destroyed.

6. The periodic maintenance of the vehicles should be done by authorized services at the intervals specified in the user manual delivered with the vehicle. Vehicles that are not serviced on time will be out of warranty. The responsibility in this regard belongs to the consumer who owns the vehicle.

7. The warranty given by our company does not cover the faults that may arise from the use of the vehicle in question for other than its purposes or in abnormal conditions, and the below-mentioned faults are also out of warranty;

- Failures caused by adding parts or parts not produced or sold by Volta Motor to the vehicle,
- Water intake of parts as a result of washing with high-pressure washing,
- Bending, breakage or deterioration of parts such as axle, differential, gearbox, motor and wheel as a result of using the vehicle above the maximum carrying capacity specified in the technical documents,
- Malfunctions arising from modifications made without the written approval of Volta Motor,
- Wearing, aging and loss of performance of battery, pad, tyre, belt and similar parts as a result of use,
- Contact of electronic components with water,
- Loading the shock absorber and chassis fasteners above the carrying capacity written in the user manual or breaking as a result of hard impact, bending,
- Damages and malfunctions that may occur as a result of disasters such as fire, flood, flooding and lightning,
- Batteries are products with a shelf life. Batteries that have been kept unused for more than 90 days (by the dealer or the end user),
- Damages that may occur during, loading, unloading and transportation of the vehicle after delivery to the user.

8. No one other than the consumer whose identity is stated on the Invoice and Warranty Certificate of the vehicle can claim any right or compensation.

9. The consumer may apply to the Consumer Arbitration Committee or the Consumer Court in the place of residence or the consumer transaction, in case of disputes that may arise regarding the use of his rights arising from the warranty.

NOTES

NOTES

[illegible]

NOTES

[illegible]



ENGINEERED BY ELECTRIC